

Installation manual VARANDA AWNING

V2.0 REV20220825



2 people

PRE-INSTALLATION INFORMATION

Necessary tools



Important



Before Installation, check the levelness of the place where you are going to apply the awning. Dimensions must be parallel and level. If the balcony is not level, it is necessary to apply shims that allow the awning fixing plates to be correctly installed.

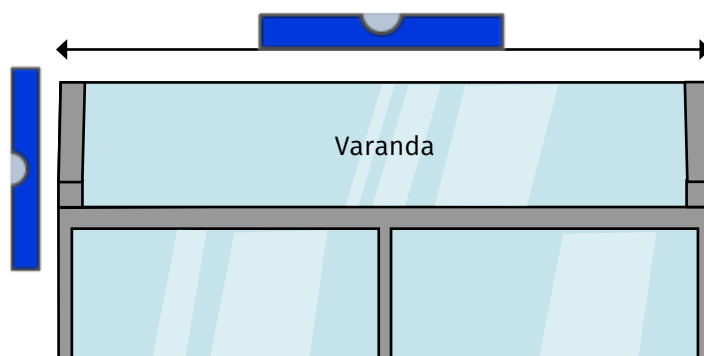

1 Inside the package

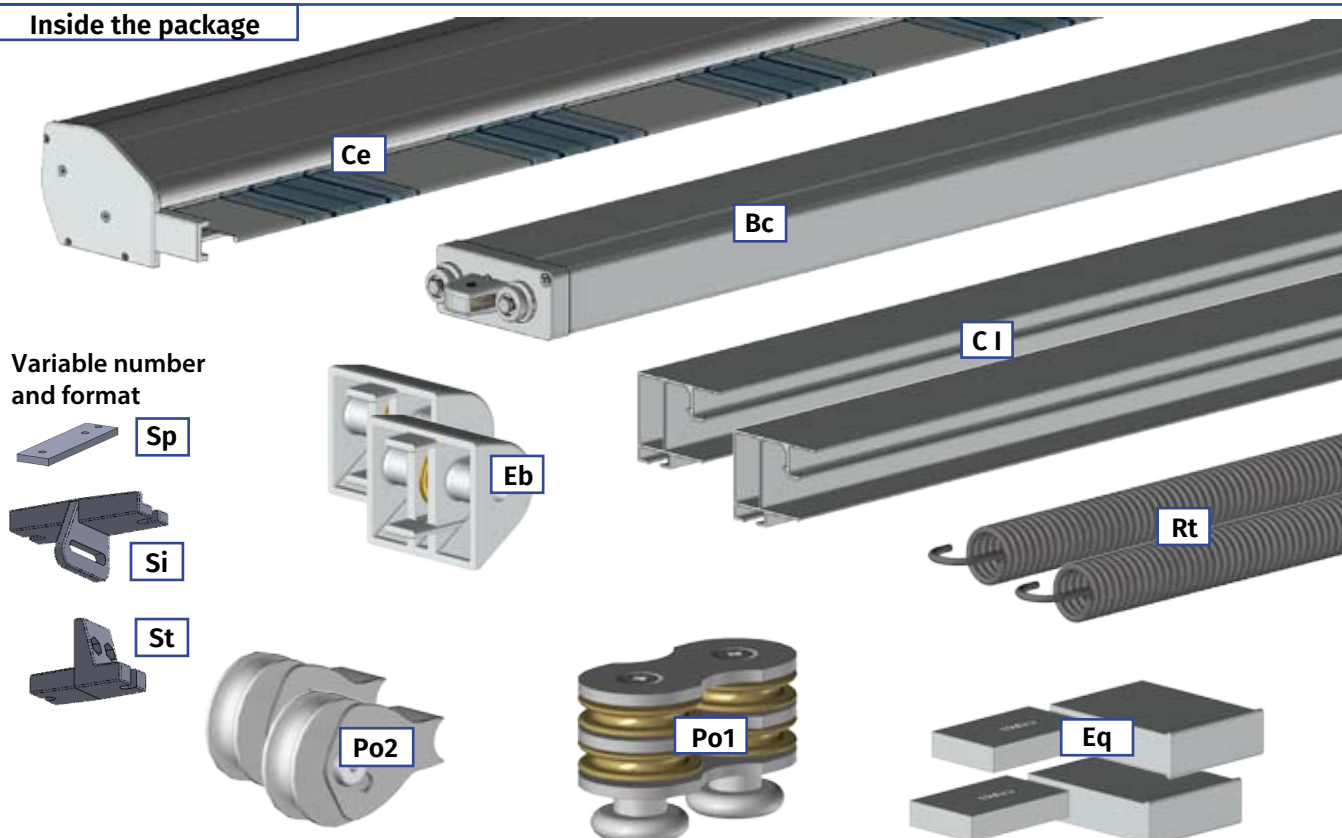

Note: Screws included, with the exception of screws that will connect **St** to a structure of the customer's choice.

2 Preparation of the cassette and front profile

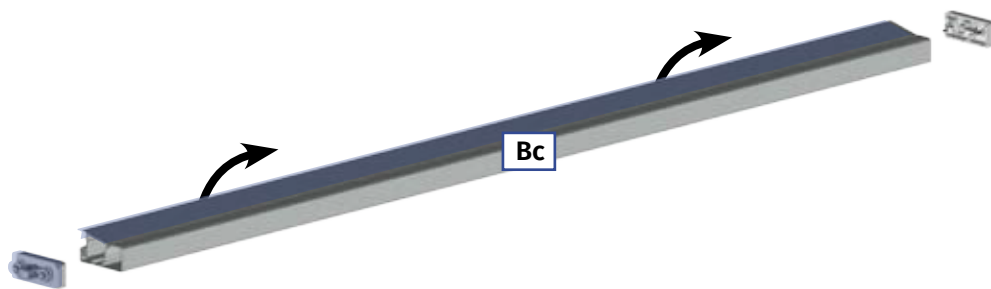

A Disassemble

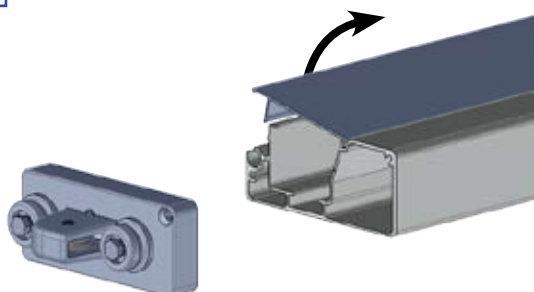

B Assemble

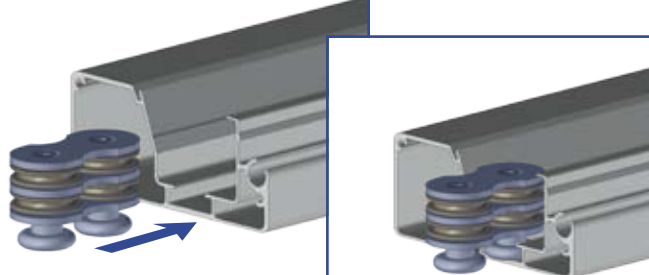

C Slide front profile on fabric

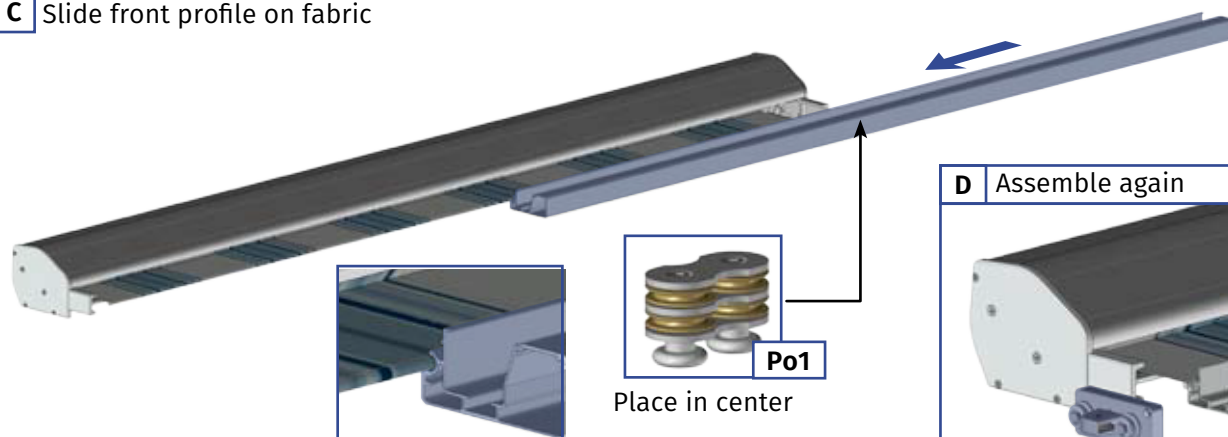

D Assemble again



3 Preparation of fixing supports

A Insert

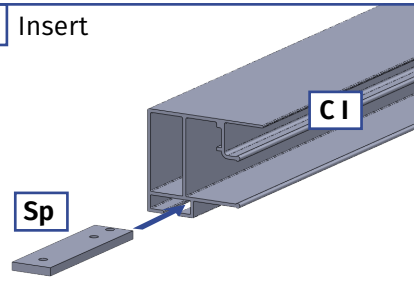

B Screw SI to Sp that is inserted into CI respecting the measurements shown on the side.

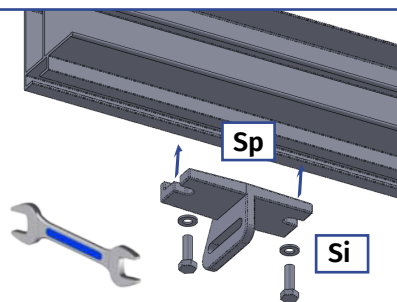

Example for 6 sets of parts (**Sp**, **Si**, **St x 6**), 3 sets for each support:

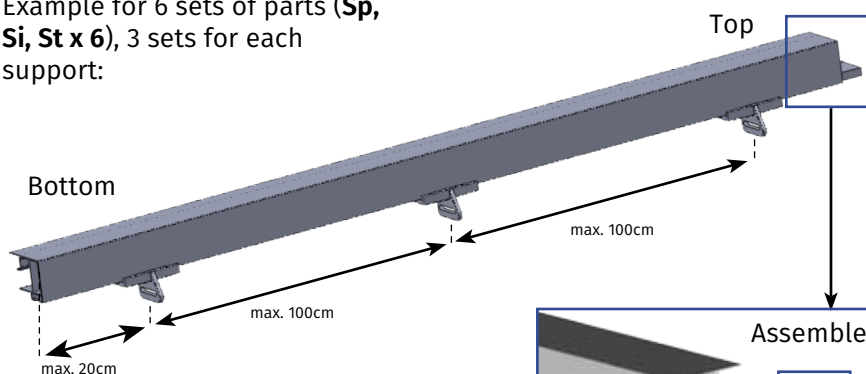

Make the same assembly for the other **CI** profile.

4 Placement of fixing plates

Varanda without support tubes

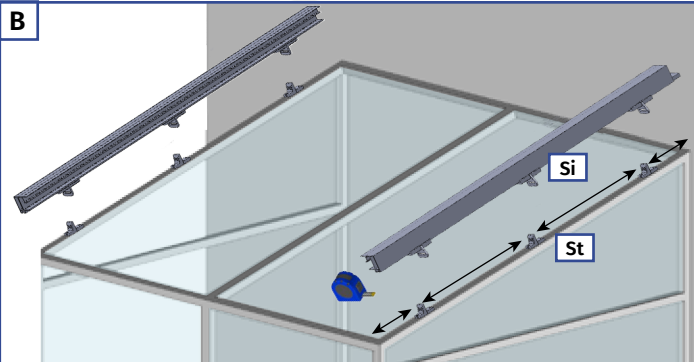
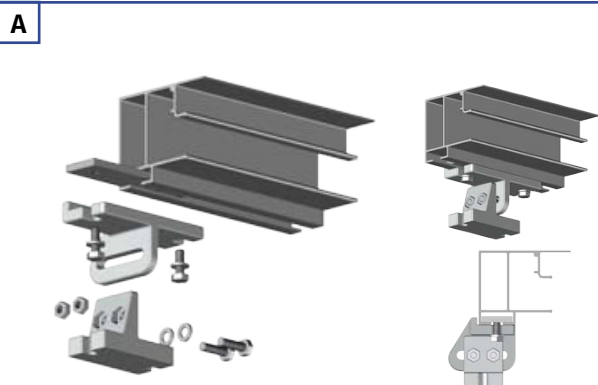

St's distances will be equal to SI's distances in CI.

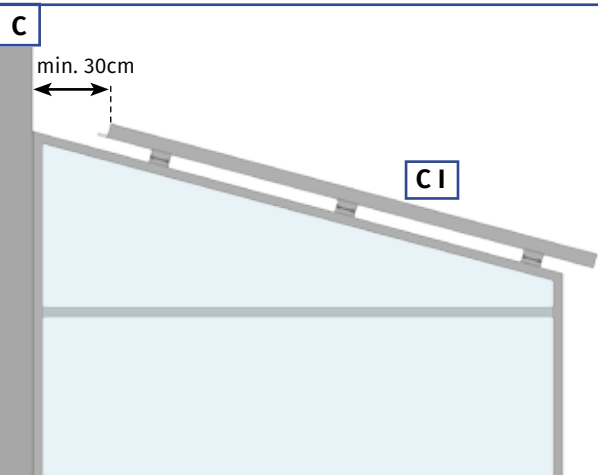

Attention, it is necessary to respect the position shown above to assemble the cassette together.

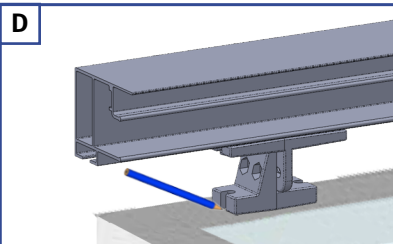

Make a mark where you will drill.

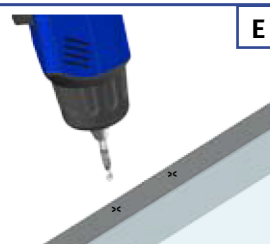

Drill in the marked areas.

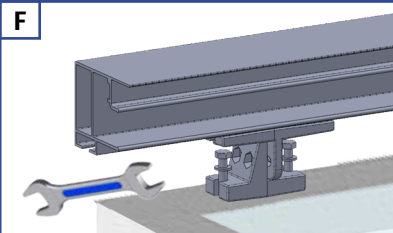

Screw St to the perforated base.

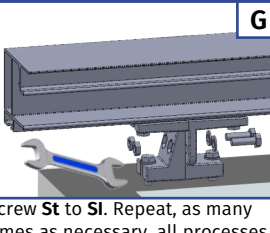

Screw St to SI. Repeat, as many times as necessary, all processes for the installation to complete.

Varanda with support tubes

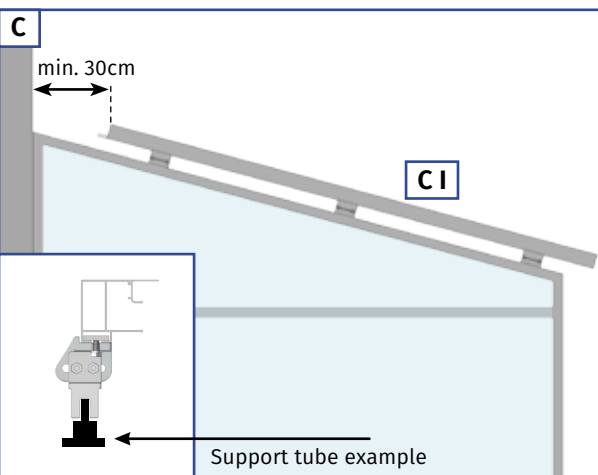
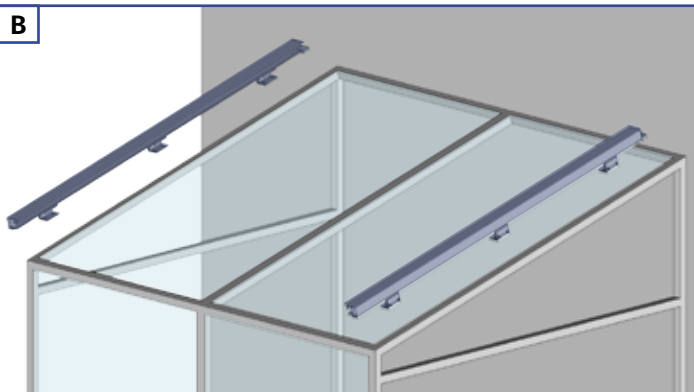
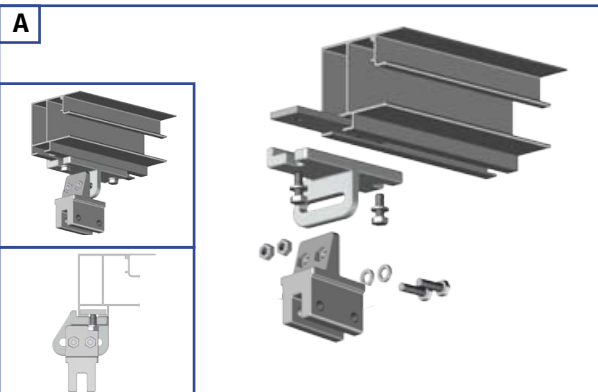

Attention, it is necessary to respect the position shown above to assemble the cassette together.

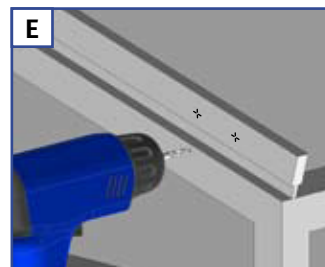
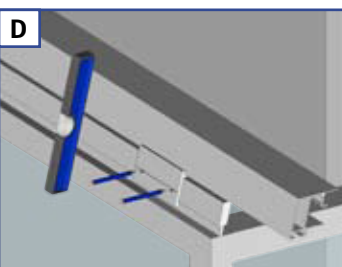

F Adapt the fixing of the awning to the type of balcony you have.

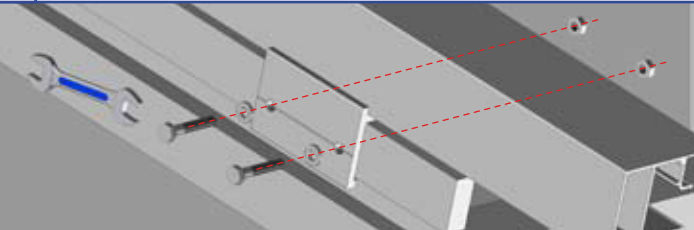

5 Other supports

Varanda without support tubes

Simple guide

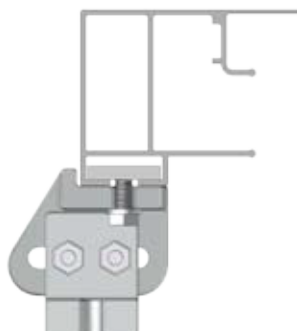
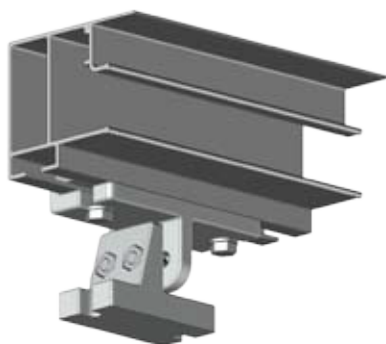

Dual Guide

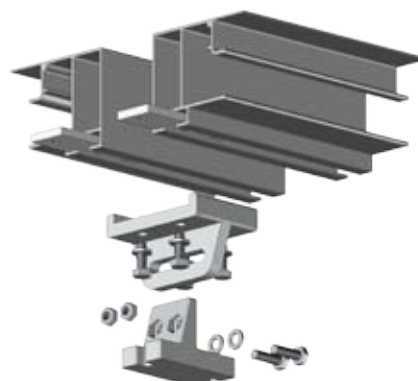
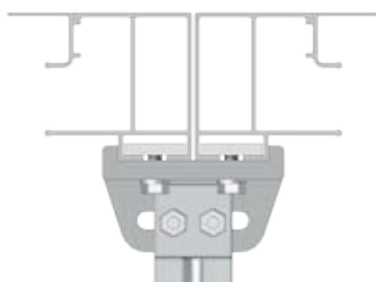

Varanda with support tubes

Simple guide

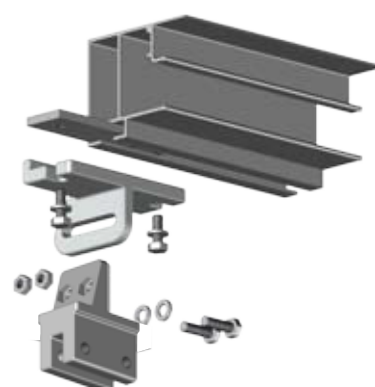
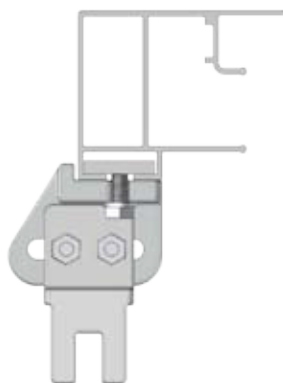

Dual Guide

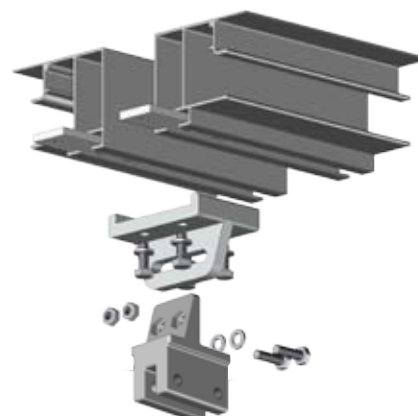
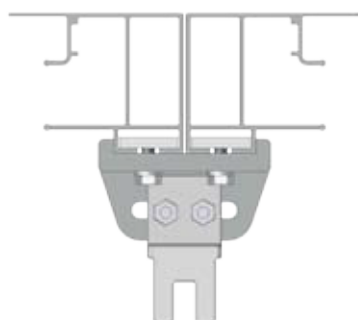

6 Cassette installation

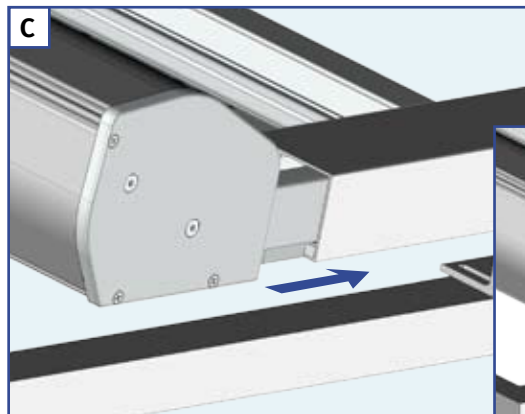
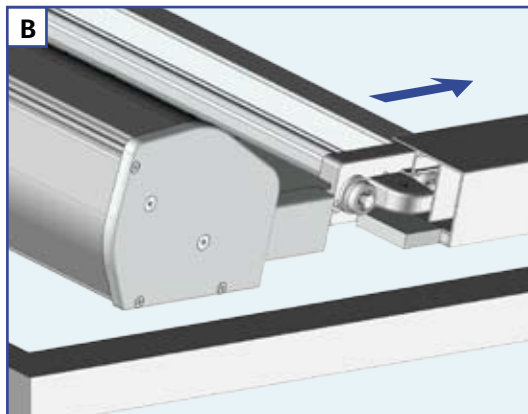
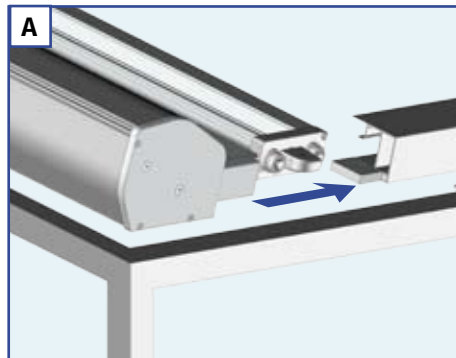
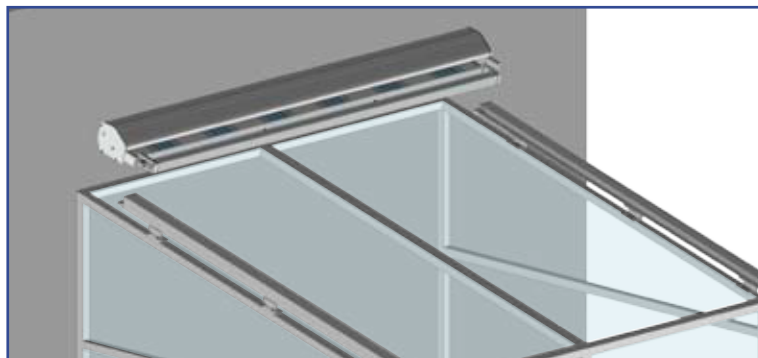

7 Placement of the maneuver rope

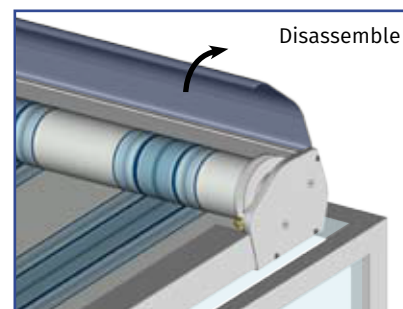
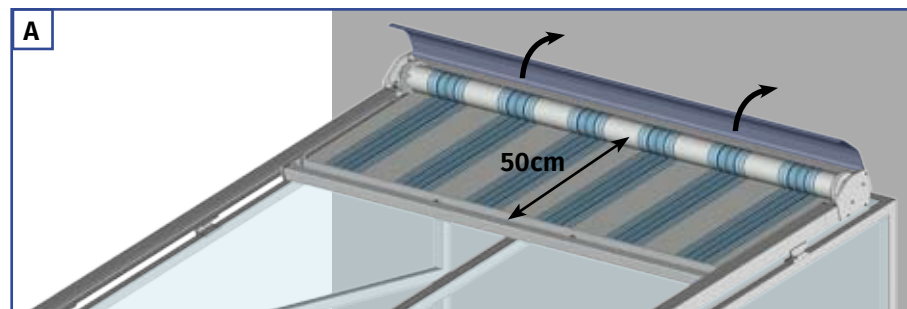

Attention, for the awning to function correctly, pay close attention to the following instructions. Operation to be carried out on the 2 reinforcements.

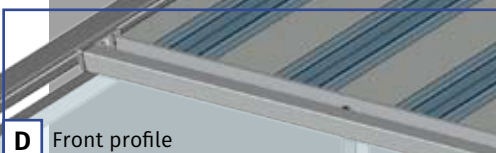
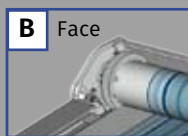

Eb



Cover

C

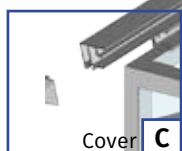

50cm

B Face

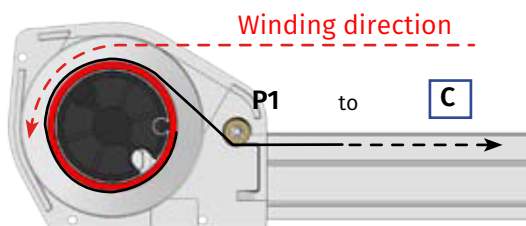

All respecting the winding direction, make 3 courses of the wire around the winding tube pulley and fix. Pass the thread under the pulley **P1** by sliding it through the guide and finding the bottom cover at **C**.



Attention, from **B** to **C**, make sure that the rope does not wrap itself, as it may break after a lot of use.

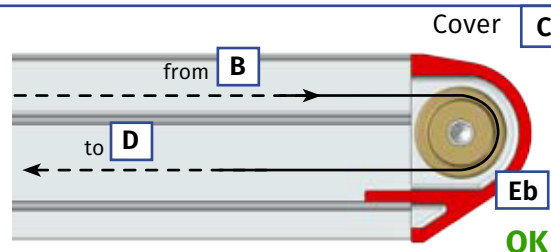

Then, slide the rope through the profile, pass the rope through the pulley and slide it again along the profile to the load bar. Attention: the cover will be placed when the rope is tensioned.

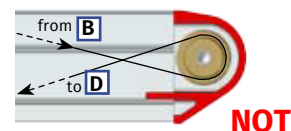

Direction of travel the rope takes when it is assembled (overview)

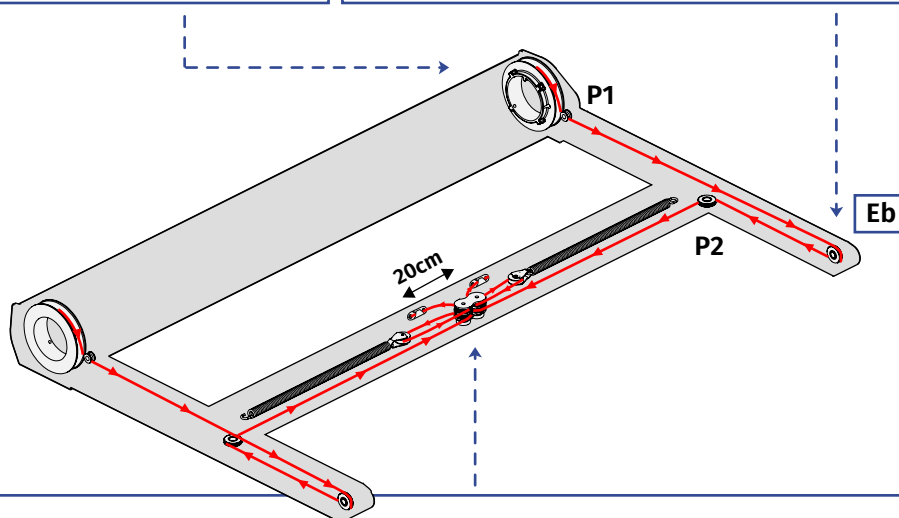

D Front profile

1 2 part pre-assembly

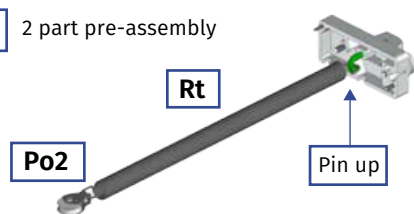

2

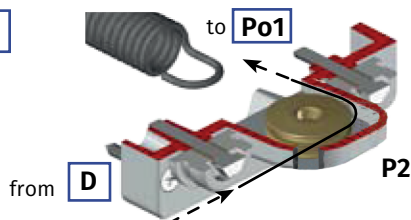

3

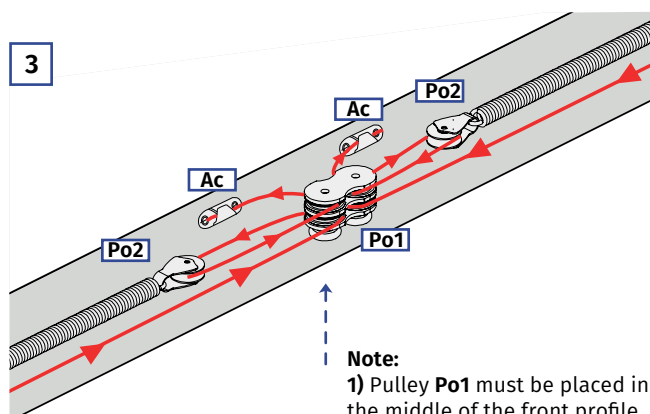

Note:
1) Pulley **Po1** must be placed in the middle of the front profile.
2) **Po1** → **Ac** = 20cm
3) The rope passes first under and then over **Po1**.

8 Fabric tension

Pull the end of the rope by hand and lock in the grip. The tension must be identical on both sides, to verify that the pulley is well positioned in the center of the front profile. Make sure the rope is properly guided on all the pulleys in the system. Open the awning all the way down. Place the awning with 50 cm of opening, to make more tension of the rope. Perform an opening and closing maneuver. The fabric must be taut.

9 Limit switch regulation

Course stoppers are factory preset. To manually adjust see next page.

10 Finalization

After the adjustments have been made, replace the cassette cover and the front profile cover by tightening the two screws.

End of assembly

Consumer information

1 Electronic operation

Use the remote control to open and/or close the awning electronically.

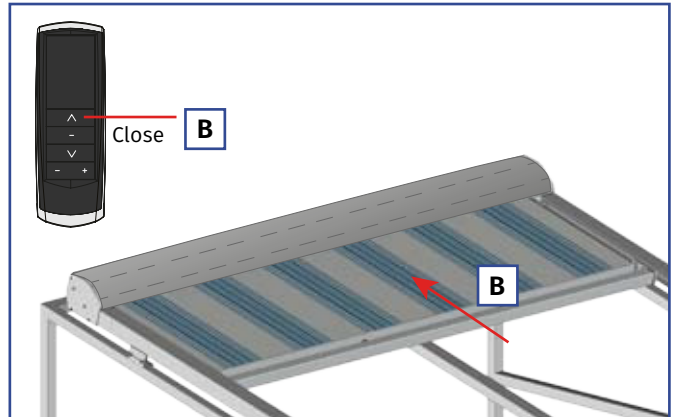
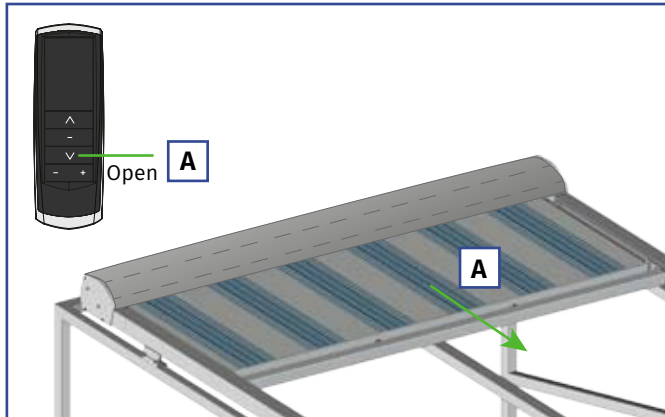

2 Manual operation

In the event of a breakdown or power failure, use the awning in manual mode with the help of the emergency crank.

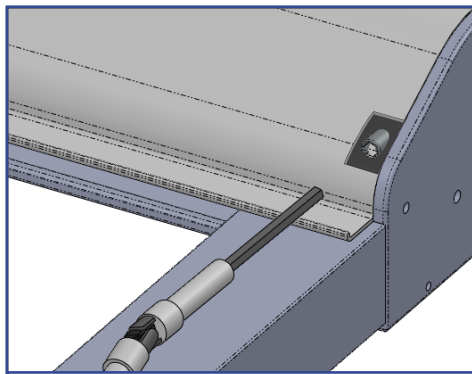

Insert the emergency crank as indicated in the figure above.

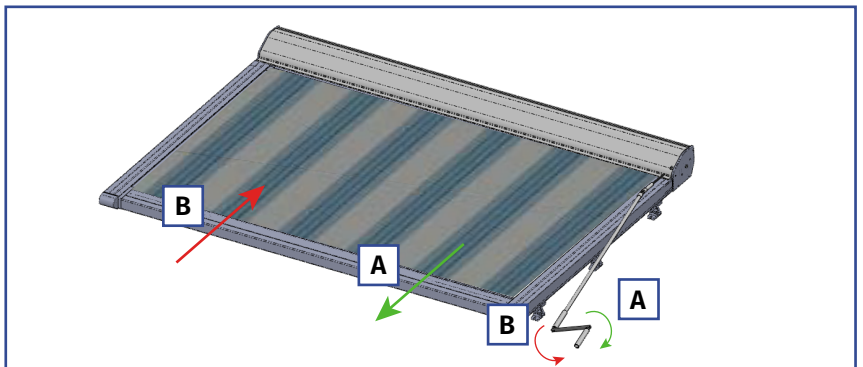

To open, turn the emergency crank to the right. To close, turn the emergency crank to the left.

3 Limit switch regulation

Course stoppers are factory preset. To adjust, open the awning. Then open the cassette and on the right side you will see the mechanism as shown in the figure to the side.

A To adjust the closing:

- Close the awning and then open it up to 30cm;
- On the mechanism, use the tuning key on the lower protrusion;
- When turning to the right, the awning closes more;
- When turning to the left the awning opens more.

B To adjust the opening:

- Awning open to the end;
- On the mechanism, use the tuning key on the upper protrusion;
- When turning to the right, the awning opens more;
- When turning to the left, the awning closes more.

Note: When regulating several times, the motor may need to rest.

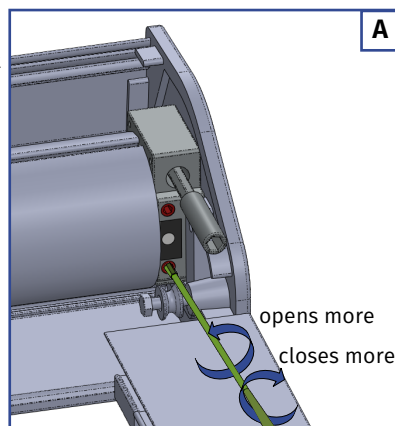

Limit switch - closing

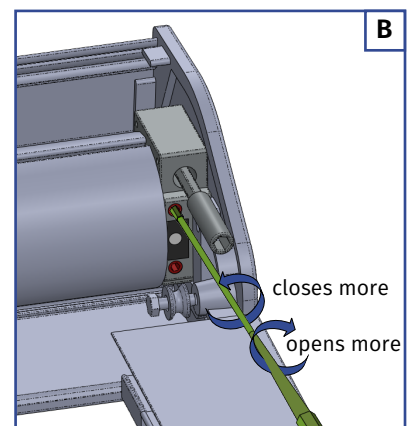

Limit switch - opening

Awning maintenance tips

An awning is subject to some adverse situations: humidity, sea air, counterweight, wind, among others. We recommend:

- check the tightness of screws and limit switches after installation and regularly at the beginning and end of each season;
- never roll up a wet awning. Dry it if possible;
- clean the fabric and frame at the beginning and end of each season. Attention, never use detergents.

Problems	Causes	Solutions
Varanda awning disintegrated from the structure.	The fixing supports are not adapted to the structure's composition.	<ul style="list-style-type: none"> ► Check the correct placement of the supports (as indicated in the manual). ► In case of fixing with a chemical anchor bolt, report to the manufacturer.
The front profile does not work normally.	The rope came off from a pulley. The tension of one rope is higher than the other (pulley Po1 off-center).	<ul style="list-style-type: none"> ► Check the entire rope circuit for possible rope displacement (paragraph 6). ► Check that the tension is identical on both sides (pulley Po1 centered - paragraph 6).
The fabric is not stretched.	Incorrect tension in the base. Fabric deformation (Natural effect).	► Tighten the rope (paragraph 7).
The awning does not open or close.	Rupture of the rope. Faulty electrical maneuver.	<ul style="list-style-type: none"> ► Do the complete circuit of the rope again (par. 6). ► Test the electrical part to find the problem.
The electric awning maneuvers do not work.	The motor goes into thermal protection after two successive descents and one ascent.	► Wait for the end of protection (20 minutes).
The electric awning maneuvers do not work.	Connection problem.	<ul style="list-style-type: none"> ► Check the motor connection. ► Check the operation of the motor by connecting directly to the electrical input (blue black or blue brown).

Do not install the awning in the event of:



Wind



Rain



Snow

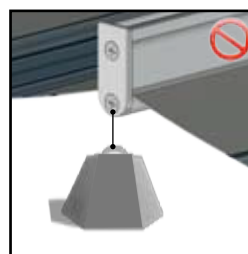

Nothing suspended

EXPLODED VIEW

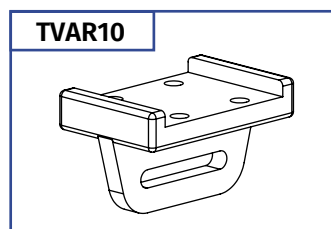
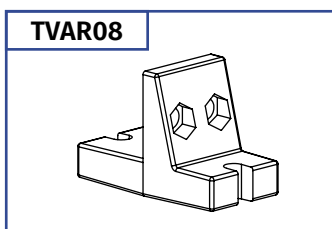
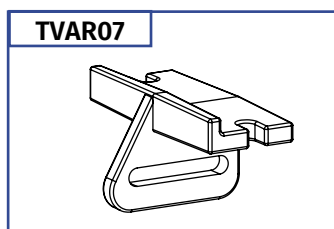
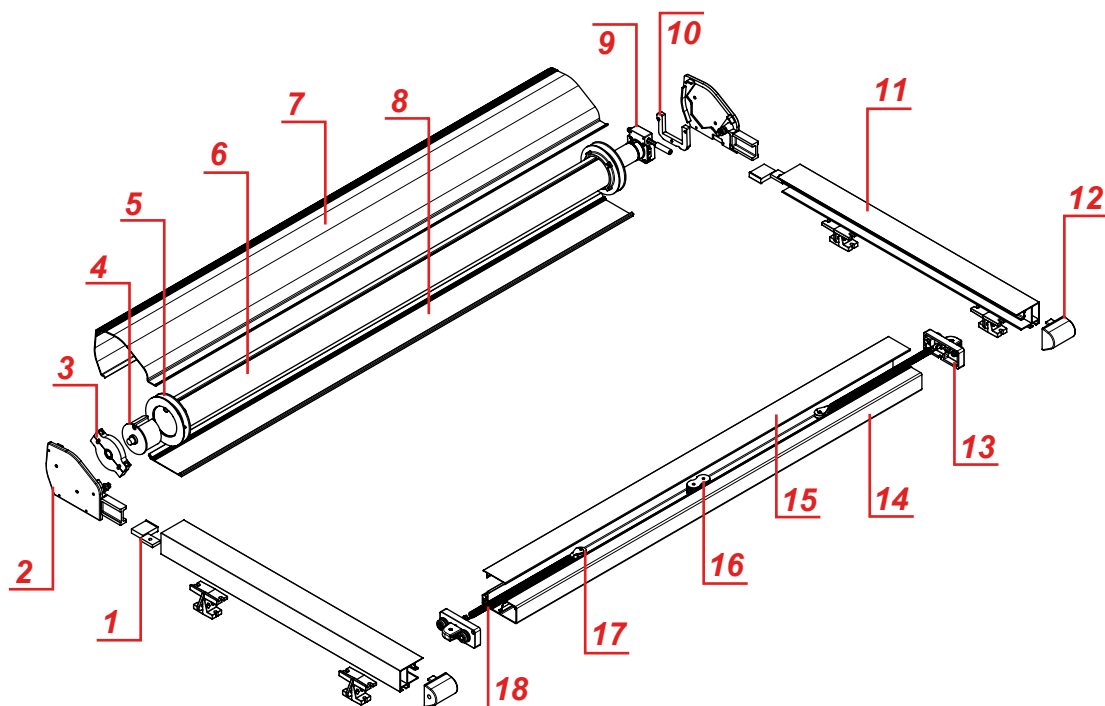

Number	Reference	Designation
1	TVAR19	Cassette Guide
2	TVAR04/05	Cassette lateral covers
3	MTTCU14A	Tube Support Ø 78mm
4	MTC678P	Tube Bushing Ø 78mm
5	TVAR17	Cassette pulley
6	MTL001	Tube Ø 78mm
7	TVAR14/15	Cassette Superior Profiles
8	TVAR13	Cassette Bottom Profile
9	TUB90M8MT	Tubular motor
10	TVAR24	Motor support
11	TVAR01	Guide
12	TVAR16	Guide cover
13	TVAR06	Strut cover
14	TVAR03	Strut profile
15	TVAR02	Strut Profile Cover
16	TVAR23	Fabric Tension Pulley
17	TVAR22	Fabric Tension Spring Pulley
18	TVAR09	Fabric Tension Spring
N.R*	TVAR18	Rope
N.R*	TVAR20/21	Rope Brakes

* the part is not represented